

Series 500 ELS

Linear Power Shaker



VGS Configuration Optional

Linear motion, high volume

The Series 500 ELS is a practical linear motion shaker that incorporates higher g forces and longer strokes than standard elliptical or orbital shakers for better separation of slurries and solids. For the price of a standard elliptical or orbital shaker you can acquire a linear motion machine from Fluid Systems, the leaders of solids control technology.

Exceptional reliability

The Series 500 ELS is unequalled in high reliability. It's low maintenance vibrators are specifically designed for years of maintenance free service. Advanced engineering insures quiet, smooth operation. The low profile and low weir height (24") makes the Series 500 ELS ideal for "tight" areas. Screen panels can be installed or replaced independently of each other. Replacement takes less than five minutes and requires only a light- to medium-weight hammer.

Lowest maintenance cost

Simplicity pays off. FSI equipment have the lowest operational and maintenance costs in the industry. Routine maintenance is extremely minimal. Simple visual checks of screen panels, deck rubbers, and quarterly torque checks of the vibrator motor bolts are all that is required. Fluid Systems, Inc. keeps you on-line for decades of trouble-free performance. It's that simple!

The FSI Difference

- **Low profile**
- **25.3 ft² of screening area**
- **Simple design**
- **Rugged and reliable**
- **High performance**
- **Low maintenance**
- **Quick screen panel changes**
- **Small footprint**
- **No lubrication**
- **Low noise**
- **Low weir height**



www.FSIshakers.com

Houston Office

16619 AldineWestfield Rd
Houston, TX 77032
832-467-9898
FAX: 832-467-9897

New Orleans Office

2808 Engineers Road
Belle Chasse, LA 70037
504-393-1804
FAX: 504-393-5166

Series 500 ELS

Linear Power Shaker

General Specifications

| | |
|---------------------|--|
| Series: | 500 |
| Model: | ELS |
| Motors: | Two each 1200 rpm exp. proof or non-exp. proof available |
| Bearings: | Permanently sealed and lubricated |
| Motion: | Linear, 0.23" A, 4.3 "G", 20 Hz |
| Screens: | Three each 29" x 42" pretensioned panels with <i>Wedgelok</i> fasteners |
| Screening area: | 25.3 sq. ft. |
| Overall dimensions: | 108" L x 61" W x 44 1/2" H |
| Weir Height: | 24" |

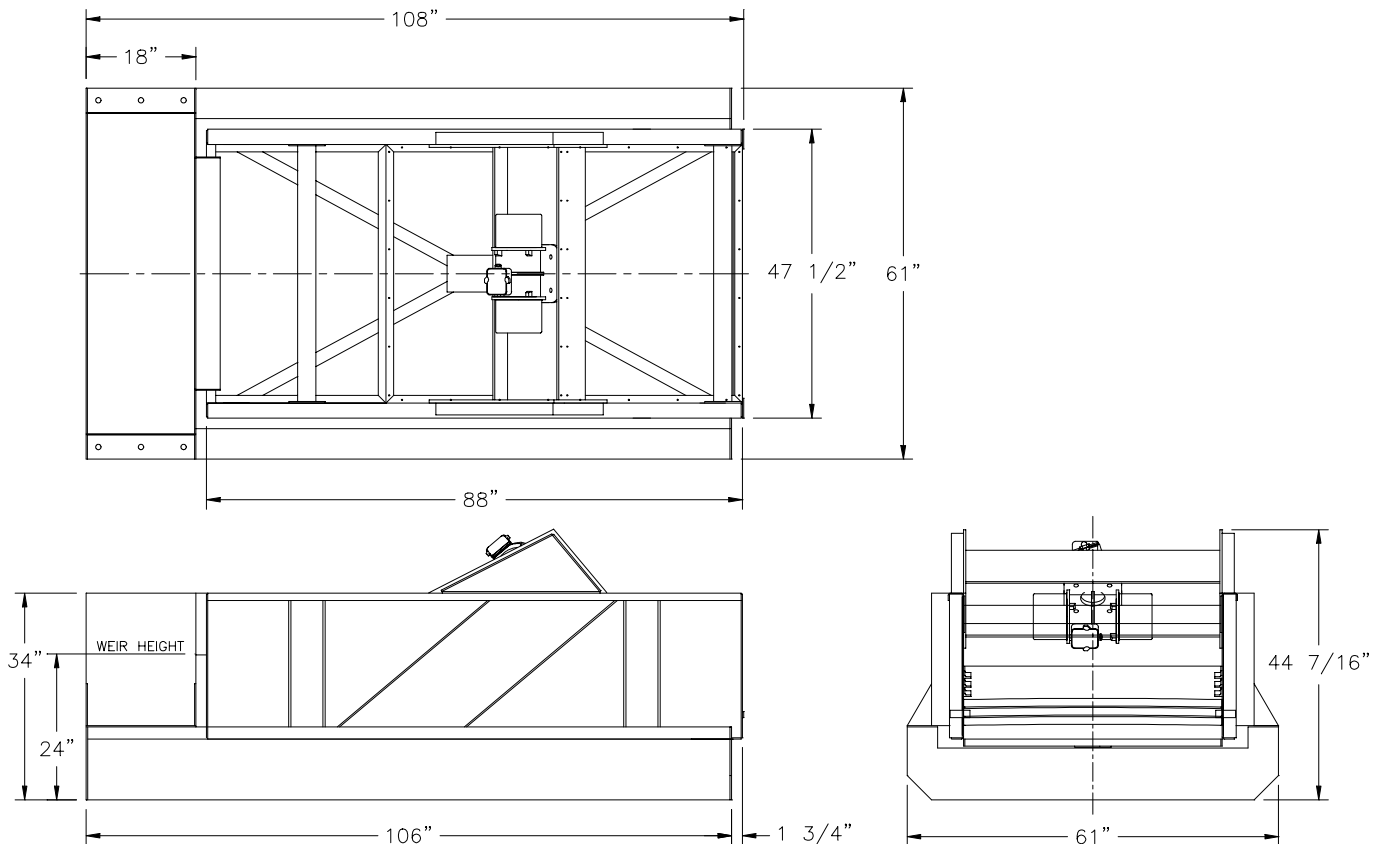

Fluid Systems, Inc.

Screen Sales, Manufacturing & Engineering

16619 Aldine Westfield Rd • Houston, TX 77032 • TEL 832-467-9898 • FAX 832-467-9898

Sales & Service

2808 Engineers Road • Belle Chasse, LA 70037 • TEL 504-393-1804 • FAX 504-393-5166

sales@fluidsystems.com • engineering@fluidsystems.com • screens@fluidsystems.com